

# The Small Cruise Ship Collection

www.small-cruise-ships.com

small-cruise-ships.com

info@small-cruise-ships.com

## KIMBELERY ADVENTURE QUEST

The 10 day Adventure Quest is an extensive exploration of the southern Kimberley, visiting many unknown sights rarely visited islands, inlets and 'secret spots'. Enjoy pristine beaches, secluded fresh water swimming holes, ancient Aboriginal art sites and fishing for Barramundi and many more fish species. This Broome to Broome loop visits icons such as the Horizontal Waterfalls, Montgomery Reef and the Kings Cascade waterfall to name a few. Your 10 day Kimberley cruise from Broome takes in all there is to offer of the southern Kimberley region allowing you to explore many breathtaking areas, discover the deep history of the region and enjoy unforgettable scenery. Please note: some departures start in Broome.

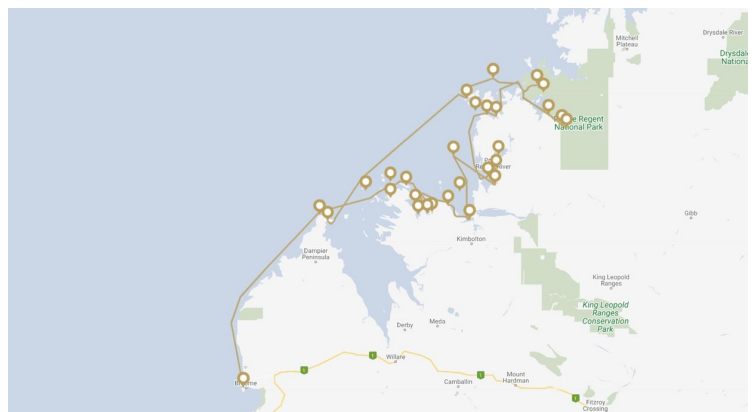

### ITINERARY

#### DAY 1: BROOME - CYGNET BAY

Your Adventure Quest begins with a scenic flight from Broome to Cygnet Bay Pearl Farm located on the Dampier Peninsular. On arrival you will learn about the fascinating history of pearling before being transferred to the Kimberley Quest II. Meet the captain and crew and enjoy lunch whilst crossing King Sound.

#### DAY 2: BUCCANEER ARCHIPELAGO, DUGONG BAY, TALBOT BAY

Wake up amongst the thousands of islands of the Buccaneer Archipelago. In and around Dugong Bay, we take a scenic tender excursion and cool off with a refreshing swim in one of the freshwater pools. Around the corner lies Talbot Bay, home to one of the icons of the Kimberley coast, the spectacular



## The Small Cruise Ship Collection

[www.small-cruise-ships.com](http://www.small-cruise-ships.com)

[small-cruise-ships.com](http://small-cruise-ships.com)

[info@small-cruise-ships.com](mailto:info@small-cruise-ships.com)

Horizontal Falls. Take a tender and head in for an up-close and exhilarating ride through this natural phenomenon. In the afternoon we take a scenic excursion up the back of Cyclone Creek to marvel at the amazing rock formations.

### DAY 3: SURPRISE FALLS, SECURE BAY

Mid morning you will visit Surprise Falls for a refreshing swim. Then enter Secure Bay, watch the incredible tidal movements as we cruise through many spectacular whirlpools. Take a scenic tender excursion to witness the colours of ancient sandstone cliffs and the stunning Kimberley Rose. Late afternoon get your first taste of fishing for giant trevally, mackerel, tuna and queenfish.

### DAY 4: MONTGOMERY REEF, SALE RIVER & RAFT POINT

Today we cruise to the amazing Montgomery Reef which covers more than 300km<sup>2</sup>, making it Australia's largest inshore reef. Watch as the tide falls right before your eyes, creating a spectacular waterfall effect. Take a tender ride to view many marine species, including turtles and sea birds. Later we explore the Sale River taking an excursion upstream for a dip in the spring-fed rainforest pools. On the journey home we view ancient rock art from the tenders. In the afternoon we cruise towards Steep Island, anchor below Raft Point and walk to the caves perched on the hill. Here is some of the finest well-preserved Wandjina art in the Kimberley. From the top we have an amazing view of the Kimberley Coast as the sun begins to set, capturing this unique landscape at its best.

### DAY 5: DOUBTFUL BAY, RED CONE CREEK, CAMDEN SOUND

This is another day packed with adventure as we cruise towards Three Ways for barramundi fishing and mud crabbing. Further exploration takes us to Ruby Falls, located off Red Cone Creek. Enjoy this picturesque freshwater swimming hole, filled with water lilies and smooth water-worn rocks to sit on and take in the tranquil surrounds. Marvel at the antics of infant whales as we cruise through the humpback breeding sanctuary of Camden Sound.

### DAY 6: CAMDEN HARBOUR, ROTHSAY WATER

Early morning we take you pelagic fishing or join our guides in search of Kimberley rock oysters. Afterwards visit Camden Harbour, scene of a 19th-century sheep farming fiasco by early European settlers. In this rugged setting and harsh climate, the settlement failed miserably and was abandoned after less than two years. Mid afternoon we cruise towards Rothsay Water to take a tender excursion exploring ancient Bradshaw and Wandjina art.

### DAY 7: PRINCE REGENT RIVER, KING CASCADE, CATHEDRAL FALLS

Cruising up the Prince Regent River, marvel at the pristine waterway that cuts through sandstone cliffs and gorges. We arrive at the King Cascade which is a spring-fed waterfall, surrounded by lush ferns and a myriad of wildlife. Climb above the falls for an unforgettable swim in a massive crystal clear pool. Be rewarded with a breathtaking view over the magnificent



## The Small Cruise Ship Collection

[www.small-cruise-ships.com](http://www.small-cruise-ships.com)

[small-cruise-ships.com](http://small-cruise-ships.com)

[info@small-cruise-ships.com](mailto:info@small-cruise-ships.com)

Prince Regent River in the distance - wilderness adventuring at its best! Late afternoon join our guides for an excursion to Cathedral Falls, while spotting crocodiles and flying foxes. Alternatively fish the Price Regent River which is renowned for big barra and threadfin salmon.

#### DAY 8: HANOVER BAY, BOOBY ISLAND

Enjoy a tender excursion around historic Hanover Bay and learn about the naming of Treachery Head and the exploits of explorer George Grey (1837). Cruise out past the scenic sandstone and basalt islands of Brunswick Bay. Marvel at the remote seabird colony of Booby Island and try your luck at pelagic fishing.

#### DAY 9: HEYWOOD & CHAMPAGNY ISLAND

Spend the day exploring the spectacular crystal clear beaches of Heywood and Champagne Island. Visit a historic secret radar base from World War II, which is a truly fascinating heritage site. Walk on a deserted beach then enjoy a refreshing swim. The final leg of your journey takes you towards Cape Leveque as you savour your last evening enjoying the sunset, whilst marvelling at the spectacular humpback whales.

#### DAY 10: CYGNET BAY, BROOME

This morning enjoy your last breakfast on board, then wave goodbye to the crew of the Kimberley Quest II before boarding a scenic flight back to Broome. On arrival (approximately 12.00pm) in Broome a courtesy vehicle will transfer you to your

accommodation.

#### Please Note:

Whilst the published itinerary can be used as a guide, due to weather, tidal movements and the nature of cruising in the Kimberley itineraries may be subject to change. Each evening on-board your cruise the Captain will discuss the coming days planned activities and experiences and you will have the opportunity to discuss the activities and ask questions.



# The Small Cruise Ship Collection

[www.small-cruise-ships.com](http://www.small-cruise-ships.com)

[small-cruise-ships.com](http://small-cruise-ships.com)

[info@small-cruise-ships.com](mailto:info@small-cruise-ships.com)

## YOUR SHIP: KIMBERLEY QUEST II

<b>YOUR SHIP:</b>	<b>Kimberley Quest II</b>
<b>VESSEL TYPE:</b>	<b>Luxury Expedition</b>
<b>LENGTH:</b>	<b>24 metres</b>
<b>PASSENGER CAPACITY:</b>	<b>18</b>
<b>BUILT/REFURBISHED:</b>	<b>2005</b>

The Kimberley Quest II has been designed for relaxing and exploring the Kimberley coastline in complete comfort and style. This custom-built vessel is fully air-conditioned, equipped with a helipad, spa, large en-suited cabins and offers indoor and outdoor alfresco areas so there will always be plenty of room to take in the panoramic scenery and breathtaking sunsets. Whilst on board take advantage of the extensive library, including a fantastic array of Kimberley reference books and general interest novels, otherwise sit with the Captain in the wheelhouse and learn more about the Kimberley outback. Accommodating just 18 passengers and 6 crew, your holiday of a lifetime can be enjoyed with fellow travelers in luxurious and intimate surrounds. You have the choice of 9 cabins from deluxe twin, double, superior and the exclusive flybridge. All cabins feature private ensuites, individual air-conditioning, viewing windows, mini-refrigerators and are serviced daily by your hostess. Carrying three excursion tenders, days are filled with a myriad of activities both on and off land, exploring the spectacular region with your very own local guide who has extensive knowledge of the Kimberley coastline. During your cruise you are free to do as much or as little as you wish and can be sure that your

Kimberley Cruise with us will exceed your



expectations!

The Small Cruise Ship Collection  
[www.small-cruise-ships.com](http://www.small-cruise-ships.com)

**01432 507 280** (within UK)

[info@small-cruise-ships.com](mailto:info@small-cruise-ships.com) | [small-cruise-ships.com](http://small-cruise-ships.com)

# The Small Cruise Ship Collection

[www.small-cruise-ships.com](http://www.small-cruise-ships.com)

[small-cruise-ships.com](http://small-cruise-ships.com)

[info@small-cruise-ships.com](mailto:info@small-cruise-ships.com)

## INSIDE YOUR SHIP

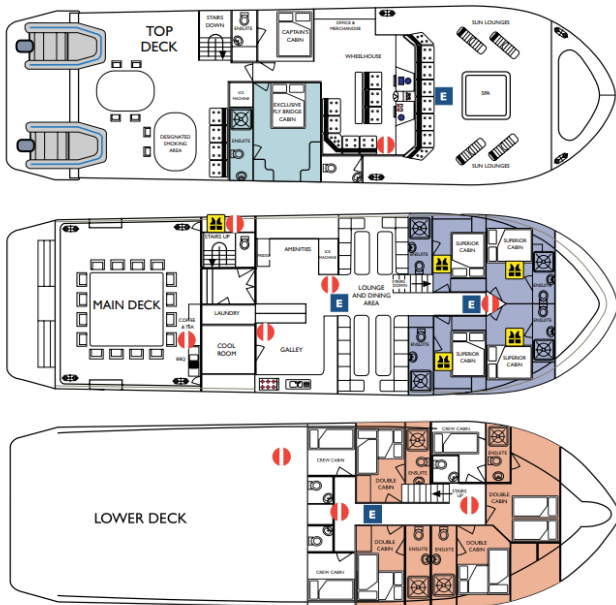

Double Cabin



Flybridge Cabin



Superior Cabin





# The Small Cruise Ship Collection

[www.small-cruise-ships.com](http://www.small-cruise-ships.com)

[small-cruise-ships.com](http://small-cruise-ships.com)

[info@small-cruise-ships.com](mailto:info@small-cruise-ships.com)

## PRICING

### 12-Sep-2025 to 19-Sep-2025

Flybridge Cabin	£8619 GBP pp
Superior Cabin	£7599 GBP pp
Double Cabin	£7089 GBP pp

### 19-Sep-2025 to 28-Sep-2025

Superior Cabin	£7599 GBP pp
Double Cabin	£7089 GBP pp
Flybridge Cabin	£8619 GBP pp

### 29-Sep-2025 to 08-Oct-2025

Double Cabin	£7089 GBP pp
Superior Cabin	£7599 GBP pp
Flybridge Cabin	£8619 GBP pp