

The Small Cruise Ship Collection

www.small-cruise-ships.com

small-cruise-ships.com

info@small-cruise-ships.com

COLUMBIA & SNAKE RIVERS JOURNEY WITH NAT GEO SEA BIRD & SEA LION

Travel along the Columbia and Snake Rivers as early explorers, settlers, and natives did—by the waterways that stretch far inland from the Pacific Ocean. You'll experience the region's history, harvests, and landscapes sailing through a beautiful land that offers access to fantastic wineries, places to kayak and hike, and extraordinary scenery. Taste local fruit from a nearby orchard and enjoy views of Mt. Hood and Mt. Adams. Learn of the struggles experienced by Meriwether Lewis and William Clark while they made their way to the Pacific Coast. And on our spring itinerary spend a lively day in bountiful Walla Walla, Washington, where you'll enjoy a special lunch and tasting at one of the city's celebrated wineries.

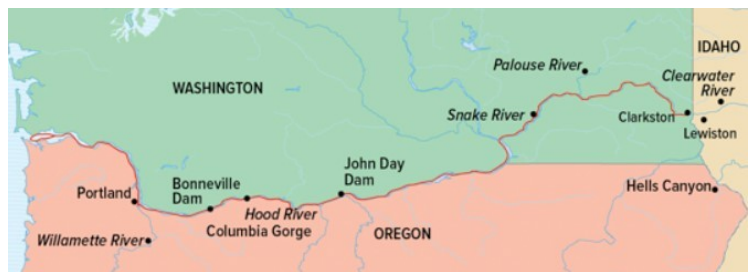

ITINERARY

DAY 1: Portland, Oregon / Embark Ship

Arrive in Portland located on the Columbia and Willamette Rivers in the shadow of snow-capped Mt. Hood. The city is known for its ecofriendliness, microbreweries, and coffeehouses. This afternoon board our ship and discover why Portland is nicknamed "Bridgetown" as we sail under eight of the city's 12 eclectic bridges along the Willamette River, the first of five rivers you will encounter on this voyage. (D)

DAY 2: Astoria

We begin our journey by navigating the Columbia to the mouth of the river at Astoria. At Cape Disappointment, where Meriwether Lewis saw the Pacific in November of 1805, explore the Lewis & Clark Interpretive Center, see Cape Disappointment Lighthouse and the north jetty of the Columbia River Bar. Visit the Columbia River Maritime Museum, which chronicles the history of river navigation and all aspects of maritime commerce in the region. Hear harrowing stories of crossing "The Bar" at the mouth of the Columbia, one of the most dangerous passages in the world. In the afternoon explore the Astoria area with several options to choose from. (B,L,D)

The Small Cruise Ship Collection

www.small-cruise-ships.com

01432 507 280 (within UK)

info@small-cruise-ships.com | small-cruise-ships.com



The Small Cruise Ship Collection

www.small-cruise-ships.com

small-cruise-ships.com

info@small-cruise-ships.com

DAY 3-4: Columbia River Gorge / Hood River

Spend your morning visiting the stunning Columbia Gorge Interpretive Center in Stevenson, Washington, featuring 15,000 years of cultural and natural history of the Columbia Gorge with displays both inside and outside. Or trek up the iconic Beacon Rock, the 848-foot basalt column that once formed the core of an ancient volcano. Lewis and Clark camped here on their way west, and it was at Beacon Rock that they first noticed the tides affecting the water levels in the Columbia River, more than 120 miles from its mouth. Continue through the Gorge to Hood River, located in the shadows of majestic Mount Hood, where you will enjoy a farm-to-table orchard lunch overlooking the golden Hood River Valley. The valley is known for its fruit-growing orchards— including one of the world's largest pear-growing areas. After lunch you'll have the option to visit the Western Antique Aeroplane & Automobile Museum and explore one of the largest collections of still-functioning antique cars and planes in the country, or trek through the Twin Mosier Tunnels on the old historic Columbia River Highway. (B,L,D)

DAY 5: Cruising

Today we will spend the day cruising through some of the most scenic and geologically interesting stretches of the Columbia River and the Columbia Plateau. Our onboard geologist and naturalists will talk with you about the Columbian Basalt Flows and the Missoula Floods that sculpted the landscape 13,000 years ago. Relive the historic tales of the Corps of Discovery through the eyes of the historian as you sail by landmarks from their epic journey. Or unwind with a massage from the wellness specialist. (B,L,D)

DAY 6: Exploring the Palouse River

The still water of the Palouse River is the perfect mirror for the surrounding basalt cliffs as we set off cruising on our Zodiac and kayak adventures. Visit Palouse Falls, where cascading waters plunge 198 feet into the pool below. These falls and the canyon are an important feature of the channeled scablands created by the great Missoula Floods that swept periodically across the region. Afterward, sail up the Snake River, enjoying a taste of local specialties. (B,L,D)

DAY 7: Clarkston, Washington

At Clarkston, we find ourselves at the confluence of the Snake and Clearwater Rivers, more than 450 miles from the sea. The name Clarkston is in reference to William Clark and is located directly across the river from Lewiston, Idaho, which is named for Meriwether Lewis, though neither of them ever traveled to the Clarkston side of the river. Travel by comfortable jet boat into one of North America's most scenic spots: spectacular Hells Canyon. The 125-mile-long canyon was carved by the waters of the Snake River and at 7,993 feet is North America's deepest river gorge—most of it inaccessible by road. The earliest known settlers in the canyon were the Nez Percé tribe and, as you travel up the river, look to the hillsides and see remnants of their ancestral horse trails along with pictographs and petroglyphs on the rock formations. In the afternoon, join your fellow travelers in the lounge for songs and stories by a local Nez Percé storyteller. This evening, enjoy the company of a local winemaker onboard. Sip their wines while you hear about how the geology of the area surrounding the Lewis-Clark Valley AVA, the newest Viticultural Area in the United States, affects the flavors of their wines. (B,L,D)

DAY 8: Clarkston / Disembark

The Small Cruise Ship Collection

www.small-cruise-ships.com

01432 507 280 (within UK)

info@small-cruise-ships.com | small-cruise-ships.com



The Small Cruise Ship Collection

www.small-cruise-ships.com

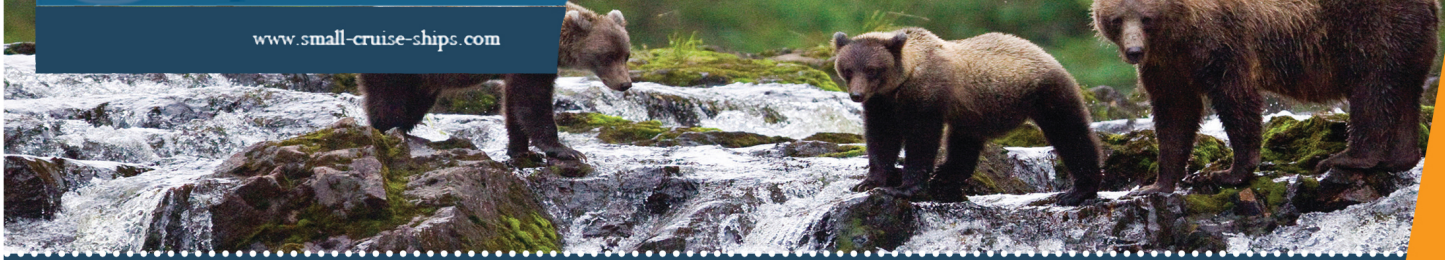

small-cruise-ships.com

info@small-cruise-ships.com

After breakfast this morning transfer to the airport for your connecting flights home. Choose to fly from nearby Lewiston, Idaho, or travel through the picturesque landscapes of the Palouse to Spokane, Washington, located two hours away. (B)

Please Note:

Itineraries are subject to change.



The Small Cruise
Ship Collection

www.small-cruise-ships.com

01432 507 280 (within UK)

info@small-cruise-ships.com | small-cruise-ships.com

The Small Cruise Ship Collection

www.small-cruise-ships.com

small-cruise-ships.com

info@small-cruise-ships.com

YOUR SHIP: NATIONAL GEOGRAPHIC QUEST

YOUR SHIP: National Geographic Quest

VESSEL TYPE:

LENGTH:

PASSENGER CAPACITY:

BUILT/REFURBISHED:

National Geographic Quest is a state-of-the-art, purpose-built expedition vessel made for exploring coastal waters, shallow coves, and fast-moving channels where wildlife congregate while sailing with the luxury of supreme comfort. Spacious cabins, open decks for wildlife viewing, and specialty tools for exploration make it the ideal platform for sailing in the remote areas of Alaska, the Pacific Northwest, Costa Rica, Panama, and Belize. Designed with decades of expedition experience in the region, National Geographic Quest more than comfortably accommodates 100 guests in 50 cabins. Her twin expedition craft landing platform allow us to rapidly get on and off the ship to take advantage of wildlife sightings and to ensure we maximize our time off the ship exploring. Created with a shallow draft, Quest draws only nine feet of water allowing her to sail into places where much larger ships cannot go.



The Small Cruise Ship Collection

www.small-cruise-ships.com

01432 507 280 (within UK)

info@small-cruise-ships.com | small-cruise-ships.com

The Small Cruise Ship Collection

www.small-cruise-ships.com



small-cruise-ships.com

info@small-cruise-ships.com

INSIDE YOUR SHIP

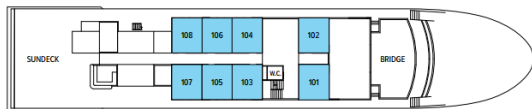

OBSERVATION DECK

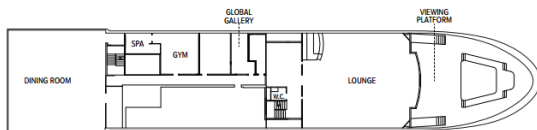

LOUNGE DECK



UPPER DECK



MAIN DECK



The Small Cruise
Ship Collection

www.small-cruise-ships.com



small-cruise-ships.com

info@small-cruise-ships.com

PRICING



The Small Cruise
Ship Collection

www.small-cruise-ships.com

01432 507 280 (within UK)

info@small-cruise-ships.com | small-cruise-ships.com