

The Small Cruise Ship Collection

www.small-cruise-ships.com

small-cruise-ships.com

info@small-cruise-ships.com

GREAT BEAR RAINFOREST AND KITLOPE - BRITISH COLUMBIA CRUISE

Dramatic landscape surrounds as you explore the coast's longest fjord, deep into the coastal mountain range towards the stunning Kitlope River Valley. In the Kitlope you'll be surrounded by steep, snow-capped peaks, rainforest, waterfalls and a great river that supports grizzly bears and moose as well as oolichan. In spring, we hope to find grizzly bears among green sedges in the estuary meadows, and colourful wildflowers like purple lupins, red paintbrush and brown northern rice root. In late summer/early fall we'll explore channels for whales and even get to some outer coastal locations, where we may see evidence of the elusive coastal wolf. There may be an early bear or two but summer is not a peak bear time in this area. Take shore excursions with knowledgeable crew to explore the Kitlope River Estuary. Relax on secluded beaches, trek through ancient rainforests, and learn about the historical significance of the Kitlope. We first explored here in 1992 at the invitation of our longtime friend Wa'xaid (Cecil Paul). The stories he told and his philosophy that helped save the Kitlope forever, and the incredible bear mother pole for his people, are captured in a book written with our naturalist Briony Penn. Thanks to this, his stories still travel with our guests as we explore together in the way he taught us to see this place. Our August trip is a Supervoyage, as it is a few days longer with more time to explore the expansive area.



ITINERARY

Day 1 Kitamaat

Board ship at Kitamaat Village, orientation, cruising into the Great Bear Rainforest, making way towards the Kitlope River, watching for marine mammals and birds. Anchorage at remote hot springs.

Day 2 Cruising

The Small Cruise Ship Collection

www.small-cruise-ships.com

01432 507 280 (within UK)

info@small-cruise-ships.com | small-cruise-ships.com



The Small Cruise Ship Collection

www.small-cruise-ships.com

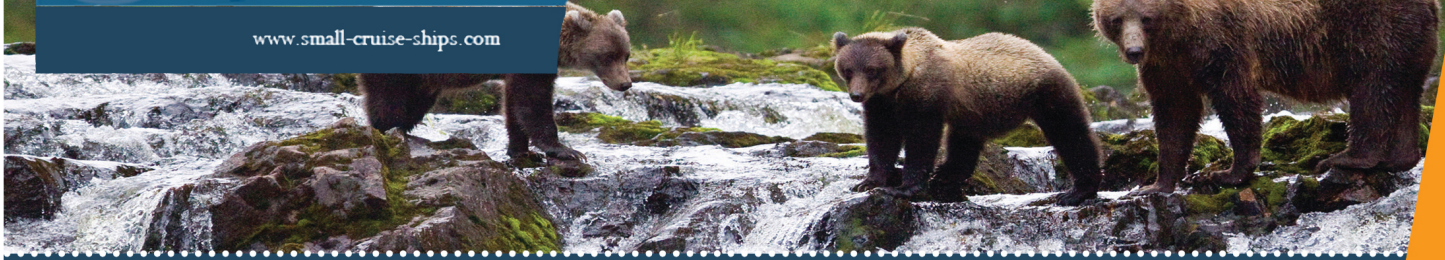

small-cruise-ships.com

info@small-cruise-ships.com

Day 6 Kitlope

Cruise to spectacular mainland inlet estuary popular with grizzly and black bears. Estuary meadow walk (wildflowers), learning about bear habitat, river exploration, look for bears.

Further exploration in the Kitlope, and/or or cruise to Kowesas to explore ashore, and then Kemaano shore trip. Cruise to hot springs.

Day 3 Whale Channel

Morning exploration ashore, then cruising Whale Channel, an aptly named waterway popular with cetaceans. Visit whale research scientists at remote station. Marine mammal viewing (several species). Anchorage at remote island on west coast. Beachcombing, hike to view, beach fire.

Day 7 Kitamaat

Cruise to Kitamaat, watching for wildlife.

Day 4 Gardner Canal

Return to mainland waterways between steep islands, through channel popular with whales. Enter Gardner Canal, the longest fjord on the coast. This waterway seems like remote wilderness but is filled with the stories and history of the Henaaksiala people, and around every turn is a new story, including some sasquatch stories, and Monkey Beach.

Please Note:

Note that as with all expedition cruises, the itinerary may change based on weather, wildlife activity, and interests of the guests. This itinerary is to give you a general idea of the trip.

Day 5 Kitlope

Sail deep into the coast mountains, leaving the outside world behind as the fjord snakes past 4,000-foot peaks to the Kitlope. Go ashore in the vast Kitlope River & estuary for the amazing tale of the G'psgolox pole. Explore the river and the estuary.



The Small Cruise Ship Collection

www.small-cruise-ships.com

01432 507 280 (within UK)

info@small-cruise-ships.com | small-cruise-ships.com



The Small Cruise Ship Collection

www.small-cruise-ships.com

small-cruise-ships.com

info@small-cruise-ships.com

YOUR SHIP: CASCADIA

YOUR SHIP: **Cascadia**

VESSEL TYPE:

LENGTH:

PASSENGER CAPACITY:

BUILT/REFURBISHED:

Cascadia is a go-anywhere, expedition style catamaran. She accommodates up to 24 guests in 12 luxurious cabins, with a crew of 10. She is unlike any other vessel offering expeditions on the British Columbia coast, having been built specifically for high-quality, boutique cruises. Light, spacious and comfortable, she is also capable of reaching the wildest, most naturally rich places on the coast. Her small size and guest numbers provide an authentic, human-scale experience that respects the carrying capacity of coastal inlets and communities. Ship And Accommodations Find comfort and solitude in your private cabin or enjoy time in any of the interior or outdoor lounges, or the "open" bridge. Cascadia's large windows bring the outside in, and her separate dining area becomes a sophisticated "long table" event for meals. Her decks are wide and welcoming, with seating areas on different levels. Salon Large windows surround the salon making it a perfect place to look for whales while staying protected, chat with other guests while lounging on our comfortable sofas, or enjoy a beverage from the nearby bar. Dining Area Enjoy our chefs' fine west-coast influenced creations while watching the sun go down. Sit and discuss your day's adventure with your captain, afloat in a remote natural

anchorage. Terrace Lounge And Dining Area Dine alfresco on temperate evenings, lounge with your morning coffee, or watch the world go by during the day. This area is the perfect mix of outside and inside. Bridge of Cascadia Cascadia's bridge is open to you. You'll have 180-degree views from here, along with being able to learn about navigation and the vessel systems from our crew. On the port side, you may also enjoy our indoor-outdoor loveseat. You can watch the world go by from behind a protective window, but still have quick access to the fresh air and the deck for whale watching. Top Deck & Hot Tub Lounge on a chaise, soak under the stars, or enjoy the bird's eye view of the ship and the world around her from Cascadia's new top deck. Cabins All cabins have individual climate control, wardrobes and an outside location, with windows for natural light. All have ensuites. All are 'outside' cabins, with windows for natural light. Kayaks, Shore Boats, Naturalist Tools Cascadia has 6 double and 2 single kayaks for paddling in coves and bays, as well as two beautiful landing craft style tenders, custom designed for our program. She carries a suite of tools for exploring the natural world, including a hydrophone for listening to whales. Her library contains books on the cultural history and nature of the BC and

The Small Cruise Ship Collection
www.small-cruise-ships.com

01432 507 280 (within UK)

info@small-cruise-ships.com | small-cruise-ships.com



The Small Cruise Ship Collection

www.small-cruise-ships.com



small-cruise-ships.com

info@small-cruise-ships.com



Alaska coast.



The Small Cruise Ship Collection

www.small-cruise-ships.com

01432 507 280 (within UK)

info@small-cruise-ships.com | small-cruise-ships.com

The Small Cruise Ship Collection

www.small-cruise-ships.com

small-cruise-ships.com

info@small-cruise-ships.com

INSIDE YOUR SHIP

TOP DECK

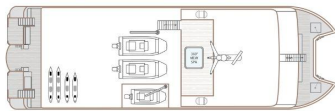

BRIDGE DECK

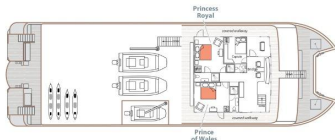

MAIN DECK



LOWER DECK

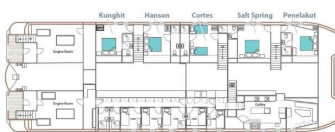

Category 1



Category 2



Category 3





The Small Cruise Ship Collection

www.small-cruise-ships.com



small-cruise-ships.com

info@small-cruise-ships.com

PRICING

21-Aug-2024 to 28-Aug-2024

Category 1	£5989 GBP pp
Category 2	£7045 GBP pp
Category 3	£8025 GBP pp



The Small Cruise Ship Collection

www.small-cruise-ships.com

01432 507 280 (within UK)

info@small-cruise-ships.com | small-cruise-ships.com