

# The Small Cruise Ship Collection

www.small-cruise-ships.com

small-cruise-ships.com

info@small-cruise-ships.com

## TASTE OF THE KIMBERLEY

This 4 day cruise offers a taste of our renowned Quest itineraries and will see you visit some of the breathtaking scenery within the southern Kimberley. This 'Taste of the Kimberley' showcases a fully operational Australian South Sea Pearl farm at Cygnet Bay. Cruise through the thousand islands of the Buccaneer Archipelago and visit icons including the incredible Horizontal Waterfalls and Montgomery Reef, Australia's largest inshore reef. You will have the opportunity to view ancient indigenous rock art and to fish for the elusive barramundi in one of the many tidal creeks or inlets the Kimberley has to offer. Exploring this region aboard the well-appointed Kimberley Quest II, accompanied by our luxury fast boat Quest Express, will leave you with the taste for more!

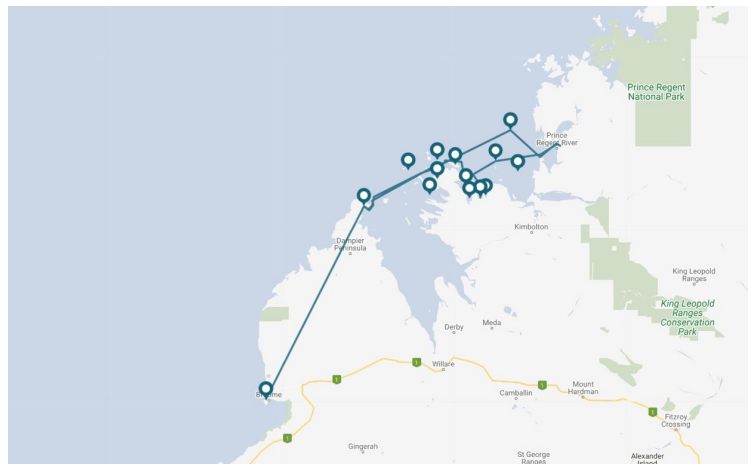

### ITINERARY

#### DAY 1: BROOME - CYGNET BAY

A courtesy vehicle will pick you up from your accommodation in Broome at approximately 9.00am. Your Quest begins with a transfer to Cygnet Bay Pearl Farm located on the Dampier Peninsula. On arrival, you will be transferred to the Kimberley Quest II, where you will be welcomed aboard by your captain and crew. Enjoy lunch whilst crossing King Sound, cruising through the thousand islands of the Buccaneer Archipelago; this is your first taste of the Kimberley. Cool off with a refreshing swim in one of many Kimberley freshwater pools, followed by a scenic tender excursion. This evening you can witness one of the spectacular Kimberley sunsets.

#### DAY 2: TALBOT BAY, DUGONG BAY & KINGFISHER ISLANDS

This morning will find us exploring Talbot Bay, home to one of the icons of the Kimberley coast; the spectacular Horizontal

The Small Cruise Ship Collection

www.small-cruise-ships.com

01432 507 280 (within UK)

info@small-cruise-ships.com | small-cruise-ships.com



## The Small Cruise Ship Collection

[www.small-cruise-ships.com](http://www.small-cruise-ships.com)

[small-cruise-ships.com](http://small-cruise-ships.com)

[info@small-cruise-ships.com](mailto:info@small-cruise-ships.com)

Falls. Take an exhilarating ride through this natural phenomenon and wonder at the amazing rock formations of Cyclone Creek. In and around Dugong Bay, we take a scenic tender excursion and cool off with a refreshing swim in one of the freshwater pools. Later in the day you will have your first taste of fishing for Giant Trevally, mackerel, tuna and queenfish at the Kingfisher Islands.

#### DAY 3: MONTGOMERY REEF, STRICKLAND BAY

This morning, we cruise towards the amazing Montgomery Reef, which covers more than 300km<sup>2</sup>, making it Australia's largest inshore reef. Watch as the tide falls right before your eyes, creating a spectacular waterfall effect. Take a tender ride to view many marine species, including turtles and sea birds. Later we explore Strickland Bay visiting old pearlers graves and joining our guides in search of the elusive Barramundi and Threadfin Salmon. Before unwinding on the sun deck capturing one last sunset aboard Kimberley Quest II.

#### DAY 4 : CYGNET BAY - BROOME

Today, after one last breakfast, we disembark Kimberley Quest II. Followed by a Cygnet Bay Pearl Farm tour, offering you a rare glimpse into the life of an operational pearl farm. This experience will leave you with a deeper understanding of what makes this place unique! Here we wave goodbye with a transfer back to Broome. On arrival you will be transferred to your chosen accommodation.

#### Please Note:

This is only a suggested itinerary. The remote Kimberley region experiences large tidal movements which can affect our itinerary. We may need to vary this from time to time, however, no matter the tides, we always visit the spectacular icons of this region. There will be plenty of land and sightseeing excursions to

many untouched places, and opportunities to catch fresh fish for the table. Please note scenic helicopter flights are available on request.



# The Small Cruise Ship Collection

[www.small-cruise-ships.com](http://www.small-cruise-ships.com)

[small-cruise-ships.com](http://small-cruise-ships.com)

[info@small-cruise-ships.com](mailto:info@small-cruise-ships.com)

## YOUR SHIP: KIMBERLEY QUEST II

<b>YOUR SHIP:</b>	<b>Kimberley Quest II</b>
<b>VESSEL TYPE:</b>	<b>Luxury Expedition</b>
<b>LENGTH:</b>	<b>24 metres</b>
<b>PASSENGER CAPACITY:</b>	<b>18</b>
<b>BUILT/REFURBISHED:</b>	<b>2005</b>

The Kimberley Quest II has been designed for relaxing and exploring the Kimberley coastline in complete comfort and style. This custom-built vessel is fully air-conditioned, equipped with a helipad, spa, large en-suited cabins and offers indoor and outdoor alfresco areas so there will always be plenty of room to take in the panoramic scenery and breathtaking sunsets. Whilst on board take advantage of the extensive library, including a fantastic array of Kimberley reference books and general interest novels, otherwise sit with the Captain in the wheelhouse and learn more about the Kimberley outback. Accommodating just 18 passengers and 6 crew, your holiday of a lifetime can be enjoyed with fellow travelers in luxurious and intimate surrounds. You have the choice of 9 cabins from deluxe twin, double, superior and the exclusive flybridge. All cabins feature private ensuites, individual air-conditioning, viewing windows, mini-refrigerators and are serviced daily by your hostess. Carrying three excursion tenders, days are filled with a myriad of activities both on and off land, exploring the spectacular region with your very own local guide who has extensive knowledge of the Kimberley coastline. During your cruise you are free to do as much or as little as you wish and can be sure that your

Kimberley Cruise with us will exceed your



expectations!

The Small Cruise Ship Collection  
[www.small-cruise-ships.com](http://www.small-cruise-ships.com)

**01432 507 280** (within UK)

[info@small-cruise-ships.com](mailto:info@small-cruise-ships.com) | [small-cruise-ships.com](http://small-cruise-ships.com)

# The Small Cruise Ship Collection

[www.small-cruise-ships.com](http://www.small-cruise-ships.com)

[small-cruise-ships.com](http://small-cruise-ships.com)

[info@small-cruise-ships.com](mailto:info@small-cruise-ships.com)

## INSIDE YOUR SHIP

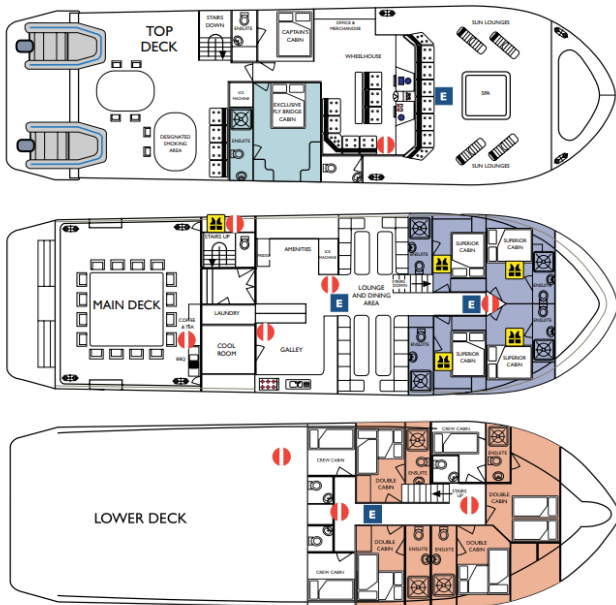

Double Cabin



Flybridge Cabin



Superior Cabin



The Small Cruise Ship Collection

[www.small-cruise-ships.com](http://www.small-cruise-ships.com)

01432 507 280 (within UK)

[info@small-cruise-ships.com](mailto:info@small-cruise-ships.com) | [small-cruise-ships.com](http://small-cruise-ships.com)



# The Small Cruise Ship Collection

[www.small-cruise-ships.com](http://www.small-cruise-ships.com)

[small-cruise-ships.com](http://small-cruise-ships.com)

[info@small-cruise-ships.com](mailto:info@small-cruise-ships.com)

## PRICING

### 08-Oct-2025 to 11-Oct-2025

Flybridge Cabin	£3564 GBP pp
Superior Cabin	£3309 GBP pp
Double Cabin	£2799 GBP pp

### 12-Oct-2026 to 15-Oct-2026

Double Cabin	£2805 GBP pp
Superior Cabin	£3315 GBP pp
Flybridge Cabin	£3565 GBP pp

### 11-Oct-2025 to 14-Oct-2025

Double Cabin	£2799 GBP pp
Superior Cabin	£3309 GBP pp
Flybridge Cabin	£3564 GBP pp

### 14-Oct-2025 to 17-Oct-2025

Superior Cabin	£3309 GBP pp
Flybridge Cabin	£3564 GBP pp
Double Cabin	£2799 GBP pp

### 03-Oct-2026 to 06-Oct-2026

Double Cabin	£2805 GBP pp
Superior Cabin	£3315 GBP pp
Flybridge Cabin	£3565 GBP pp

### 06-Oct-2026 to 09-Oct-2026

Double Cabin	£2805 GBP pp
Superior Cabin	£3315 GBP pp
Flybridge Cabin	£3565 GBP pp

### 09-Oct-2026 to 12-Oct-2026

Superior Cabin	£3315 GBP pp
Double Cabin	£2805 GBP pp
Flybridge Cabin	£3565 GBP pp